

### Adapter Coupling Installation Instructions: Compression Outlet for PE Gas Pipe

1. Verify that the compression outlet is the correct size for the polyethylene pipe.
2. Remove the compression nut and seal ring from the outlet to prevent heat damage to the seal ring during the welding procedure. Place them in the plastic bag in which the service tee was shipped.
3. Weld the adapter coupling per your company's welding procedures.
6. Install the compression nut and seal ring onto the outlet. Do not tighten the compression nut.
7. Cut polyethylene pipe end square, deburr inside and outside, clean thoroughly to assure there is no dirt, grease, oil, etc. on assembly area of pipe.
8. Mark stab length on pipe (see examples for correct pipe or tubing size and corresponding stab length).

#### IMPORTANT

##### For use on:

Polyethylene gas pipe meeting the requirements of ASTM D 2513

**Pressure Rating:** Designed to meet or exceed pressure rating of PE pipe per 49 CFR Part 192 and ASTM D 2513

**Operating Temperature:** -20 to 140° F

**Material:** Carbon Steel



9. Insert the polyethylene pipe through the compression nut until it bottoms in the outlet. (See detail "A")
10. Tighten compression nut until it shoulders against the outlet. (See detail "B") The stab length line should be no more than 3/16" from face of the compression nut.
11. If the stab length line is more than 3/16" from the face of the compression nut, disassemble the joint and repeat steps 6 through 10.

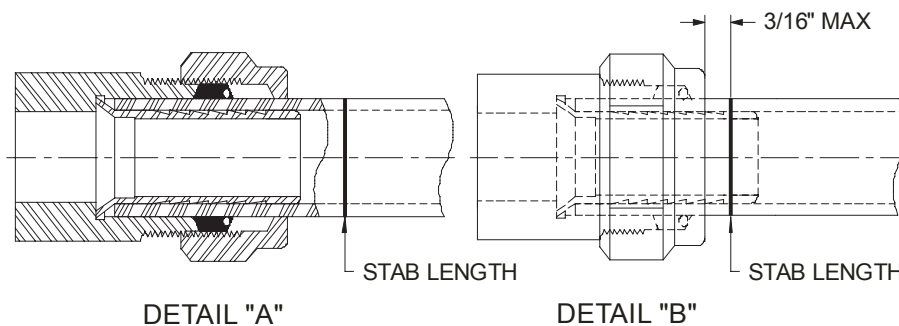

12. To assure proper assembly and to comply with 49 CFR 192 Subpart J—Test Requirements, the joint shall be leak tested.

ECN 2625 REV "E" 08/25/14